



Fallow Rise
, Hertford, SG13 7NL
£1,100 Per month

Fallow Rise, Hertford, SG13 7NL

Greenhill Estates are delighted to be marketing for let this immaculate one bedroom, ground floor apartment located in a desirable neighbourhood within walking distance of Hertford Town Centre and Hertford East mainline railway station serving direct access to London Liverpool Street and Tottenham Hale train stations. Hertford North station is also within easy reach serving direct access into Finsbury Park and Moorgate.

This modern apartment is immaculately presented offering spacious accommodation comprising of a bright open plan lounge/dining area, a modern kitchen, a good sized double bedroom with space for large wardrobes, and a newly fitted kitchen. The property has recently undergone renovation works creating a stylish home for those looking for modern and convenient living.

The property is also offered with allocated parking and there is also ample visitors parking as well, viewing is strongly advised to appreciate this wonderful home.

Ready for occupation June 2022.



Area Map

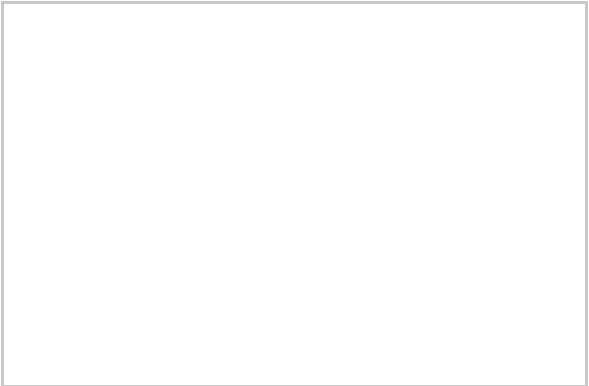

Floor Plan

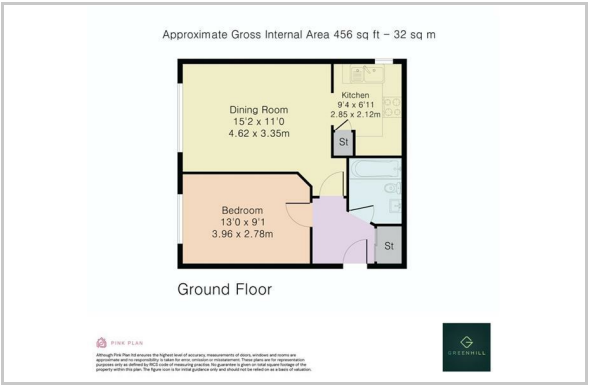

Energy Efficiency Graph

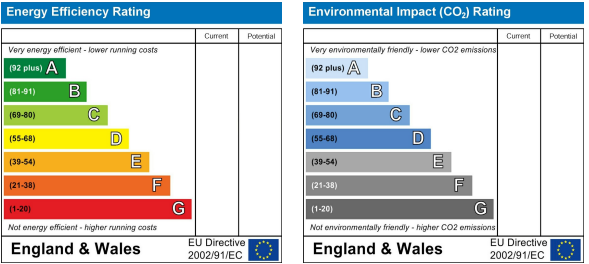

These particulars, whilst believed to be accurate are set out as a general outline only for guidance and do not constitute any part of an offer or contract. Intending purchasers should not rely on them as statements of representation of fact, but must satisfy themselves by inspection or otherwise as to their accuracy. No person in this firms employment has the authority to make or give any representation or warranty in respect of the property.